

Green & Environment Audit report 2016-17

Date : 02-05-17 to 07-05-17

1. Aim & objective

- 1) Survey of pollution and environment of college campus.
- 2) Practical education regarding pollution to the students of Biological science.
- 3) Continuous watch on waste management.
- 4) Plantation programme and gardening
- 5) Cleanness in campus
- 6) Beautification of college campus.

2. Location of the college

Gopalpur College , Gopalpur, Balasore

Mouza- Sarangpur Po- Jageswer pada

Via- Gopalpur Ps- Khantapara, Dist- Balasore

State- Odisha

Plot no 06- (1 acre) , Plot no-07 (81 decimel) and plot no- 1690,1691,1695,1696,1697

With total area -13.5 acre

Year of establishment 1978

3. Mode of survey

- a) Pond- 90'x80'x6'
- b) General garden.

4 Study of pollution

- Science laboratory- chemistry laboratory of this college releases SO_2 $(NO)_x$ CO_2 etc.
- Vehicular pollution- more than 1000 two wheelers, four wheelers coming to the daily.
- BCR, GCR, SCR, office of this college release pungent odour having on NH_3 .
- A number of vehicles pass through the nearby salt road which cause air pollution.

5. Other difficulties

- This college is very prone to cyclones, flood in each year. It has faced 1999 super cyclone, bulbul, fani & oyer cyclone in each other. So a number of plant are uprooted & dwindled..
- College is only 10 km away from seashore.

A salt road passes near to the college. So vehicles exhaust enters to the college & polluting air.

4. Remedial measures

a) Waste management: -

The official wastes like cartons, waste paper, fallen leaves, cow dung are collected and dumped into a pit. These are biologically degraded, the humus is collected and used in garden and Plantation

b) College Garden

To beautify the campus diff. Type of medicinal plants, flowering plant are planted. Seasonal flower are also planted in each season. The Permanent flowering plant are croton, Arcania, pasiflora , peniwinkle, henna, Jasmine ,gardenia, chamap jasmine cymas, might jasmine, rose etc.

Future Plane

Different type of plants are to be planted around the play ground and in subhadra ladies hostel. There is also a plan to make a medicinal garden in front of laboraonic. In Subhadra women hostel.

Appraisal repost

This audit is done by eco-club established in the dept. Of Botany. The durability or effectiveness of such report is one year in normal condition.

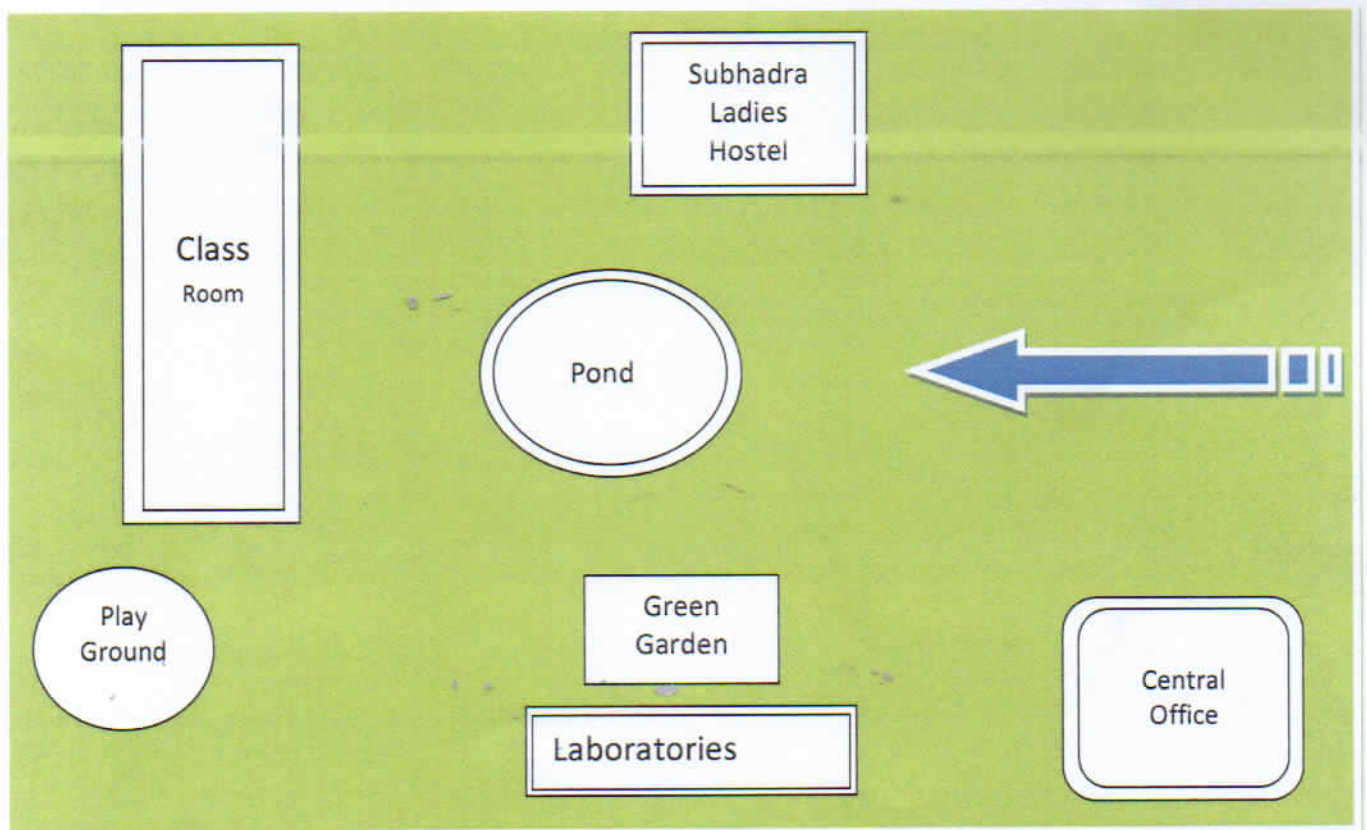

Green Population Study

Name	Full grown	Young	Sapling	Uprooted	Total
Acacia	130	10	10	20	170
Bakul	15	5	5	00	25
Jamun	03	00	00	00	03
Sinisha	07	00	00	00	07
Betelnut	07	03	00	00	10
Paper plant	02	00	00	00	02
Neen	51	09	00	00	60
Kanchan	01	00	00	00	01
Sik Cotton	01	00	00	00	01
Radhachuda	11	02	00	00	13
Arjun	03	00	00	00	03
Batapi	-	01	-	-	01
Chhagalbati	01	-	-	-	01
Coconut	04	-	-	-	04
Red wood tree	08	-	-	-	08
Banyan	00	01	-	-	01
Jui	02	-	-	-	02
Mango	20	03	00	-	23
Sapota	09	00	-	-	09
Margosa	00	03	-	-	03
Champak	02	-	-	-	02
Nageswar	01	00	00	00	01
Debadaru	57	07	0	-	64
Guava	03	02	-	-	05
Muchakund	01	-	-	-	01
Tamarind	01	-	-	-	01
Janglibadar	01	-	-	-	01
Teak	25	22	00	-	47
Euqualiptes	10	01	-	-	11
Arcania	03	-	-	00	03
Palmyra palm	04	02	-	-	06
Prunus	-	02	-	-	02
Diospyros	-	01	-	-	01
Buanla	09	06	-	-	15
Karuna	00	01	-	-	01
Total	398	78	15	20	502

Umesh Ch. Sanigrahi
Signature of
Green Audit Officer

Narain Kumar Pashe
Principal 07/05/17
Gopalpur College, Gopalpur, Balasore
Gopalpur, Balasore.